

MILL SIZE	A	B	C	D
12"	14 1/2"	18 1/2"	13 1/2"	38 1/2"
18"	20 1/2"	24 1/2"	19 1/2"	44 1/2"
24"	26 1/2"	30 1/2"	25 1/2"	50 1/2"
30"	32 1/2"	36 1/2"	31 1/2"	56 1/2"
36"	38 1/2"	42 1/2"	37 1/2"	62 1/2"
42"	44 1/2"	48 1/2"	43 1/2"	68 1/2"

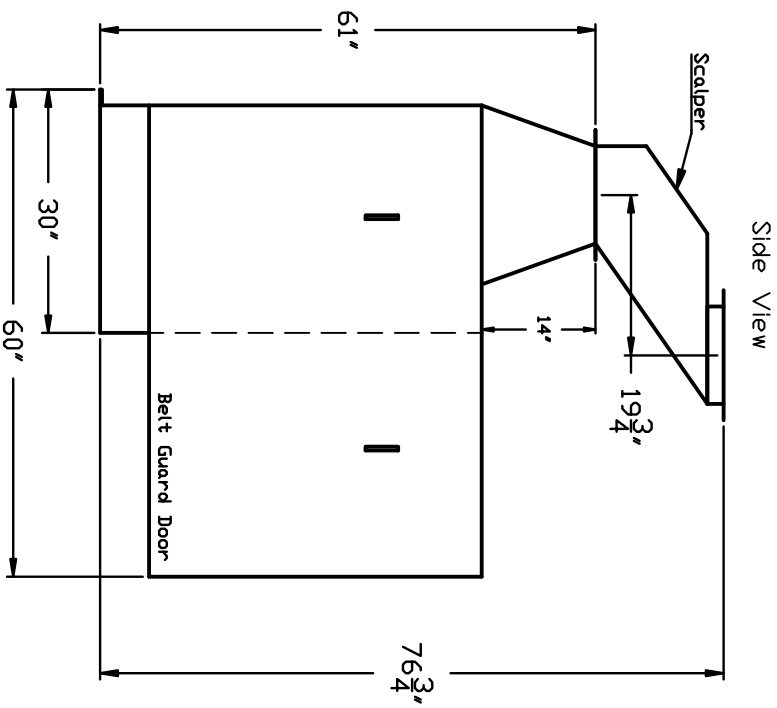

Note: Bottom Hopper is built to customer specifications.

RMS Roller Grinder Inc.
 2716 GRUWAND AVENUE
 IFA, SD 57054-6113
 Phone: 888-283-9337

Description: Commercial Mill Outline